

SERIES CEE
SOCKET OUTLET
CODE 471472

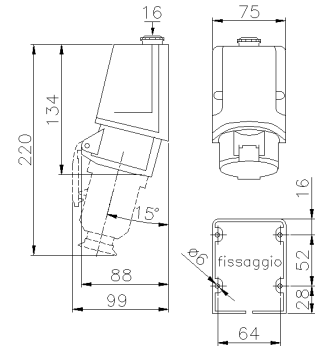

Datasheet

Specifications

Net Weight	0.275 KG
Electric system	PR16A_3P.png
Rated current	16A
Frequency	50/60Hz
IP Protection degree	IP44
Poles	3P+ $\frac{1}{2}$
Clock Position	6h
Rated operating voltage	400V ●
Rated insulation voltage	500 V V
Manufacturing material	Technopolymer Recyclable Palazzoli
Execution	Wall mounting
Hole type	Pg16
Standard plug-socket	IEC 60309-2

Reference Standards and Directives

Certification and approval marks	CB IMQ, IMQ, NYCE COLOMBIA, CE
Directives	2011/65/EU (RoHS), 2012/19/EU (WEEE), 2014/35/EU (LVD)
Reference Standards	EN 60309-1:1999, EN 60309-1:1999/A1:2007, EN 60309-1:1999/A1AC:2014, EN 60309 -1:1999/A2:2012, EN 60309-2:1999, EN 60309-2:1999/A1:2007, EN 60309 -2:1999/A2:2012, EN IEC 63000:2018

The images are purely indicative. Palazzoli reserves the right to make changes without notice.