



# BRAVO-HB HIGH BAY 150W OPTICS 90° IP65

Palazzoli  
GROUP



SERIES BRAVO  
HIGH BAY  
CODE **BVHB9840SC**

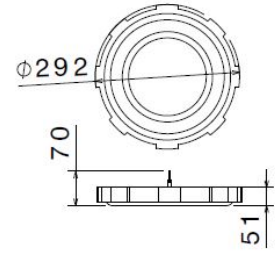
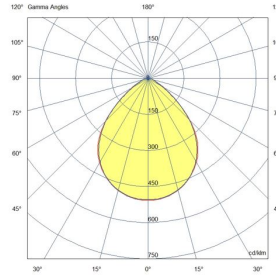

## Datasheet

### Lighting characteristics

Output flux	20,250 lm
Luminous flux (TJ=25°C)	24,730 lm
Luminaire power	150 W
Output efficiency	135 lm/W
Color temperature	4000K
Optics type	Multilenses with circular refractors
Optics	Symmetric wide
CRI	>80
Color shift	5 MacAdam Step
Photobiological risk EN 62471	RG0 - Exempt Group
Flicker free	< 3%
Life time	L80 @50.000h Tq=25°C

### Mechanical characteristics

Manufacturing material	Aluminum alloy
Surface finishing	POLYESTER PAINT STANDARD
Colour	Silver
Diffuser type	UV stabilized polycarbonate
IP Protection degree	IP65
Shock resistance	IK08 according to IEC/EN 62262
Corrosivity category	Equivalent to C2 (ISO 12944)
Mounting system	Quick hook for chain
Net Weight	1.69 KG
Working Environment Temp.	Min: -20°C ;Max: +50°C
Warehousing Temperature	Min: -40°C ;Max: +70°C

### Electrical characteristics

Insulation Class	I
Supply Voltage	110-240V AC 50/60Hz
Control system/dimming	Standard on-off
Surge protection	4kV mode com. 4kV mode diff.
Power factor	>0,95
Hole type	V099
Max conductor section	1 mm <sup>2</sup>
Tightening diameter	-

### Reference Standards and Directives

Warranty	2 years extendable to 5
Certification and approval marks	CE, UKCA
Directives	2009/125/EC (ERP), 2011/65/EU (RoHS), 2012/19/EU (WEEE), 2014/30/EU (EMC), 2014/35/EU (LVD), Reg. EU 2019/2020 (EcoDesign)
Reference Standards	EN 55015:2013, EN 60598-1:2015, EN 60598-1:2015/A1:2018, EN 60598-1:2015/AC:2015, EN 60598-1:2015/AC:2016, EN 60598-1:2015/AC:2017, EN 60598-2-1:1989, EN 61000-3-2:2014, EN 61000-3-3:2013, EN 61547:2009, EN 62311:2008, EN 62471:2008, EN 62493:2015, EN IEC 63000:2018, IEC TR 62778:2014

The images are purely indicative. The indicated values of luminous flux and declared power have tolerances of +/- 10%. Lewden reserves the right to make changes without notice.